



Quickshim Hinges

Twist-to-shim collars from LOCKT



One small twist; one big revolution

Introducing Quickshim™ the commercial grade adjustable hinge. Quickshim utilizes a patented Twist-to-Shim Collar that is designed to square doors in a fraction of the time you would need with a standard hinge. This revolutionary design is a common sense approach to reducing maintenance time and costs.

Key Features

- All hinges have templated screw hole locations for use on either wood or hollow metal doors and frames.
- Pins in nonferrous hinges are stainless steel.
- Hole in bottom tip for easy pin removal.
- Reversible flush tips and pins.
- All configurations ANSI and BHMA certified
- Packed with screws, Twist-to-Shim collars and an adjustment tool for turning collars.
- Heavyweight hinges tested to 2.5 million cycles; standard weight tested to 1.5 million cycles.
- Available with nonremovable pins (optional).
- Right-handed or left-handed.

Smart access means BEST in class



Architectural Grade

By building the shims into the leaf, we maintained the structural integrity and durability of the hinge.

Fire Rated

Enables you to maintain fire rating, because you won't need to shim with flammable materials.

Save Money

Since Twist-to-Shim collars adjust with just a few twists, they square doors in a fraction of the time you'd take with a standard hinge, reducing maintenance costs.

Popular Configuration

Quick Shim is available in our most popular 5 knuckle ball bearing designs.

Pricing and Ordering

Part number	Description	Size	Finish	Material	Handing	List Price USD	List Price CAD
7265994	QKSFBB179	4.5X4.5	26D	STEEL	LH or RH	\$30.08	\$37.88
7265995	QKSFBB179NRP	4.5X4.5	26D	STEEL	LH or RH	\$33.97	\$42.78
7265996	QKSFBB168	4.5X4.5	26D	STEEL	LH or RH	\$55.80	\$70.27
7265997	QKSFBB168NRP	4.5X4.5	26D	STEEL	LH or RH	\$60.16	\$75.77
7265998	QKSFBB191	4.5X4.5	32D	STAINLESS STEEL	LH or RH	\$55.80	\$70.27
7265999	QKSFBB191NRP	4.5X4.5	32D	STAINLESS STEEL	LH or RH	\$59.69	\$75.17
7266000	QKSFBB199	4.5X4.5	32D	STAINLESS STEEL	LH or RH	\$97.97	\$123.38
7266001	QKSFBB199NRP	4.5X4.5	32D	STAINLESS STEEL	LH or RH	\$99.18	\$124.91

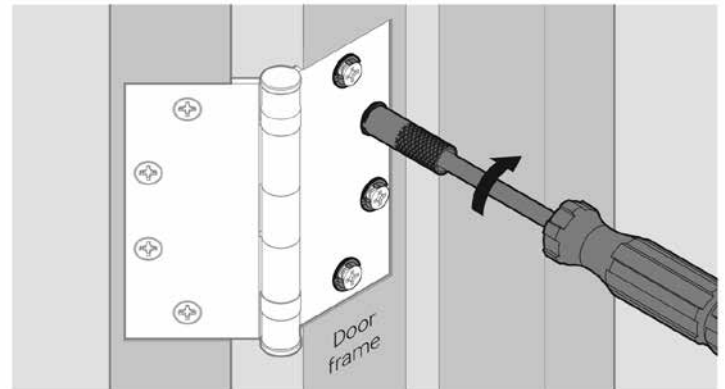
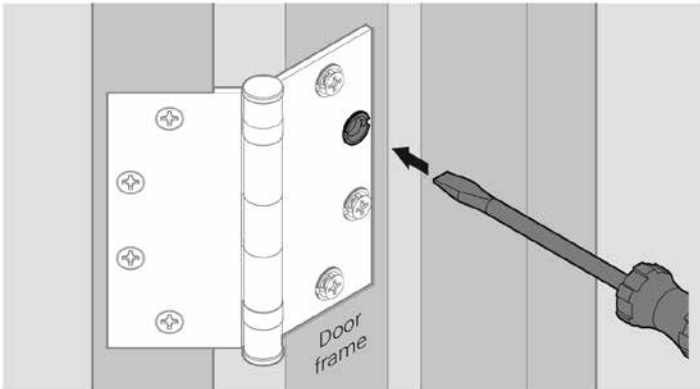

Determine which hinge needs adjustment to allow the door to hang properly in the door frame. Loosen but do not remove the screws from the hinge. For best results; only back out screws two turns.

Insert screwdriver through adjustment tool. Slide adjustment tool down to position onto the quick shim adjustable collar and turn the collar to make appropriate adjustment. Once adjustment is complete, simply tighten the screws. Repeat if alignment needs further adjustment.

For questions about ordering and to be sure you get the right configuration for your needs, [contact your BEST dormakaba sales representative](#).
6161 East 75th Street, Indianapolis, IN 46250 USA | [855-365-2407](tel:855-365-2407) | bestaccess.com